



Failure to follow WARNINGS, THULE GUIDELINES or PRODUCT INSTRUCTIONS could result in the following: **DAMAGE TO VEHICLE, PROPERTY DAMAGE AND SERIOUS PERSONAL INJURY OR DEATH.**

## Warnings

- Do not exceed the HITCH manufactures **MAX TONGUE WEIGHT** capacity.
- This accessory is rated for **Class 3** or greater 2" receiver hitches only.

Class 3 to 5  
2" Receiver

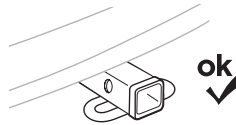

Class 1 to 2  
1.25" & 2" Receiver

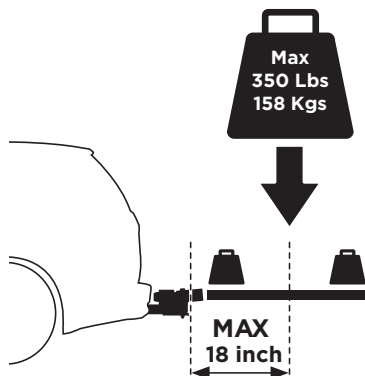
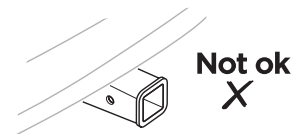

- With load centered less than 18" from Access pin hole, do not exceed 350 lbs max capacity.

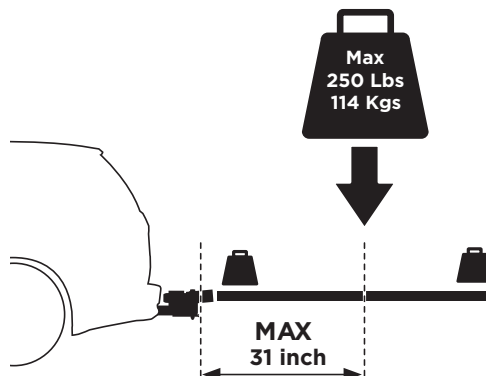

- With load centered greater than 18" from Access pin hole, do not exceed 250 lbs max capacity.



- This product is not for towing use.
- Do not use on towed vehicle.
- Do not use this product on RV's or trailers.
- This product is not approved for off-road use.

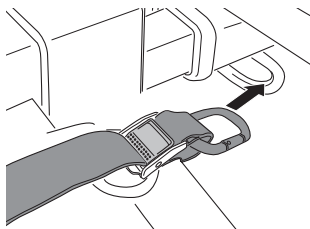

- Always use the safety strap, do not operate if damaged or missing.
- Keep hands away from **PINCH POINTS**.
- Do not allow children in the work area of this product when not in use.
- Do not attempt to move vehicle with adapter in open position.

## Caution!

- Confirm the product you intend to use is approved for use on Thule Access.
- Do not use this product upside down.
- Periodically check tightness of Thule Access in vehicle receiver.
- Make sure your rack and receiver are in good working order before use.
- Must mount to your vehicles receiver directly. Do not use hitch extenders.
- Do not take through automatic carwash.
- Obey all traffic posted traffic laws when using this product.
- The added distance and weight will amplify deflection. Drive responsibly.

## Approved Thule Bike Carrier Fits:

Product / Part number	Weight (lbs.)	Rack compatibility	Number of bike positions	Capacity (lbs.)		Lbs.	
				Each bike position	Max load	Rack weight	Total Rack and Bikes
Thule Access							
9037	55	Thule T2 Pro XT - 2 Bike	2	60	120	52	172
		Thule T2 Pro XT - 4 Bike	4	39	156	93	250
		Thule T2 Classic - 2 Bike	2	60	120	50	170
		Thule T2 Classic - 4 Bike	4	40	160	89.5	250
		Thule Range - 4 Bike	4	37.5	150	42	192

## Dimensions

Deployed Top View

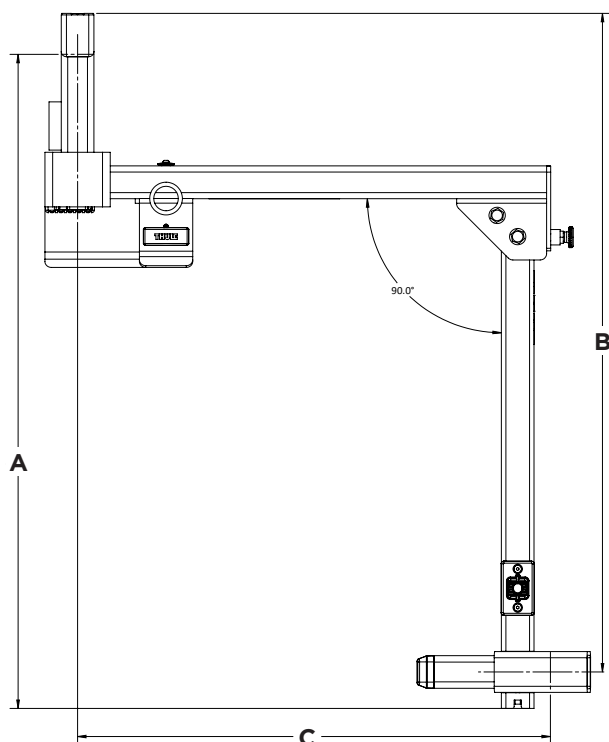

Front View



Top View

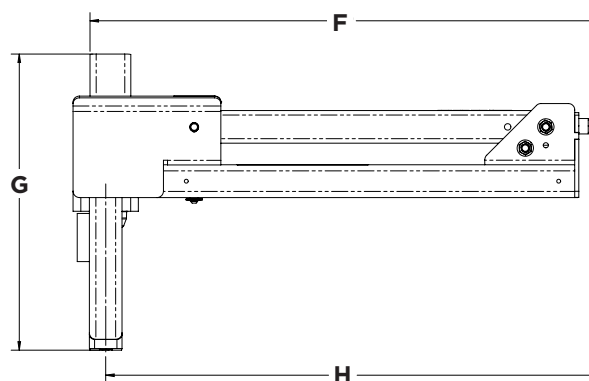

Side View

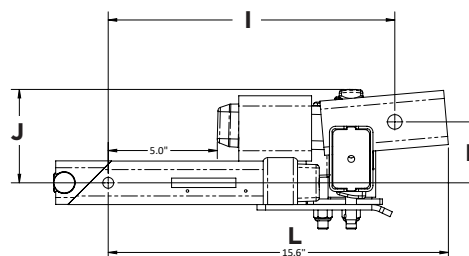

MODEL	A	B	C	D	E	F	G	H	I	J	K	L
9037	40.1"	40.4"	29"	6.4"	32.4"	31.3"	18.1"	30.4"	13.2"	4.3"	2.8"	15.6"